

[Review responses online](#) ↗







Received 4 of 4 responses  
**All responses received**

28 Brown St, Dungog NSW 2420

Job dates  
01/03/2025 → 01/03/2026

These plans expire on  
12 Jan 2025

Lodged by  
Laura Vallentine

Authority	Status	Page
 BYDA Confirmation		2
 Essential Energy	Received	4
 Hunter Water Corporation	Received	13
 NBN Co NSW	Received	22
 Telstra NSW Central	Received	36



Contact Details

Contact	Contact number	Company	Enquirer ID
Laura Vallentine	0401 202 615	Laura Vallentine Architect	3648544
Email		Address	
lauravallentine@gmail.com		36 Kestrel Avenue Salamander Bay NSW 2317	

Job Site and Enquiry Details

**WARNING:** The map below only displays the location of the proposed job site and does not display any asset owners' pipe or cables. The area highlighted has been used only to identify the participating asset owners, who will send information to you directly.

Enquiry date	Start date	End date	On behalf of	Job purpose	Locations	Onsite activities
16/12/2024	01/03/2025	01/03/2026	Private	Design	Private	Planning & Design



Check that the location of the job site is correct. If not, you must submit a new enquiry.

If the scope of works change or plan validity dates expire, you must submit a new enquiry.

Do NOT dig without plans. Safe excavation is your responsibility. If you don't understand the plans or how to proceed safely, please contact the relevant asset owners.

User Reference	Address	Notes/description
24_001_28 Brown ST	28 Brown St Dungog NSW 2420	-

Your Responsibility and Duty of Care

- **Lodging an enquiry does not authorise project commencement.** Before starting work, you must obtain all necessary information from all affected asset owners.
- If you don't receive plans within 2 business days, contact the asset owner & quote their sequence number.
- Always follow the 5Ps of Safe Excavation (page 2), and locate assets before commencing work.
- Ensure you comply with State legislative requirements for Duty of Care and safe digging.
- If you damage an underground asset, you MUST advise the asset owner immediately.
- By using the BYDA service, you agree to the [Privacy Policy](#) and [Term of Use](#).
- For more information on safe digging practices, visit [www.byda.com.au](http://www.byda.com.au)

Asset Owner Details

Below is a list of asset owners with underground infrastructure in and around your job site. It is your responsibility to identify the presence of these assets. Plans issued by Members are indicative only unless specified otherwise. Note: not all asset owners are registered with BYDA. You must contact asset owners not listed here directly.

Referral ID (Seq. no)	Authority Name	Phone	Status
248801805	Essential Energy	13 23 91	NOTIFIED
248801806	Hunter Water Corporation	1300 657 657	NOTIFIED
248801804	NBN Co NswAct	1800 687 626	NOTIFIED
248801807	Telstra NSW Central	1800 653 935	NOTIFIED

END OF UTILITIES LIST

Referral

248801805

Member Phone

13 23 91

Responses from this member

Response received Mon 16 Dec 2024 9.58am

File name	Page
Response Body	5
Coversheet_EW_ASSETS_FOUND.pdf	6
plot161063851094091529500.pdf	8
EW_ASSETS_FOUNDsafetyNotice.pdf	9

Asset Name: 50215  
Date of enquiry: 16/12/2024 9:57:00 AM  
Notification No: 38281273 (Job No)  
Sequence No: 248801805

Customer's Name: Laura Vallentine  
Customer's Phone No: +61401202615

Address supplied for dig site location  
28 Brown St, Dungog, NSW

You will require a PDF viewer such as Adobe Acrobat Reader to view the attached documents.  
Adobe Acrobat Reader is freely available at <http://get.adobe.com/reader/>.



## CABLE/PIPE LOCATION

Assets were found in the search area

<b>COMPANY NAME:</b>	Laura Vallentine Architect
<b>ATTENTION:</b>	Laura Vallentine
<b>SEARCH LOCATION:</b>	28 Brown St Dungog NSW 2420
<b>SEQUENCE NO:</b>	248801805
<b>DATE:</b>	Monday, 16 December 2024

**Provision of Plans:**

Please find enclosed plans depicting approximate locations of **Essential Energy** assets in the search location. **The excavator must not assume that there may not be assets owned by other network operators in the search location.**

Underground assets searched for	Underground assets found
Essential Energy Electrical	<input checked="" type="checkbox"/>
Essential Energy Water & Sewerage	<input type="checkbox"/>

Plans are updated from time to time to record changes to underground assets and may be updated by Essential Energy without notice. In the event that excavation does not commence within 28 days of receipt of a plan, a new plan should be obtained.

The excavator must retain the plans on site for the duration of the works.

The excavator shall report all damage made to Essential Energy assets immediately. Note that damage includes gouges, dents, holes and gas escapes.

**IN CASE OF EMERGENCY OR TO REPORT DAMAGE:  
PHONE 13 20 80**

### DISCLAIMER

Please be aware that plans may **not** reflect alterations to surface levels or the position of roads, buildings, fences etc. **Cable and pipe locations are approximate** and the plans are **not** suitable for scaling purposes. *Essential Energy does not retain plans for privately-owned underground electrical or water & sewerage assets located on private property. Privately-owned underground electrical assets located on private property are the responsibility of the owner.*

The plans have been prepared for Essential Energy's sole use and benefit. **Essential Energy cannot and does not warrant the accuracy or completeness of the plans.** Essential Energy supplies them at no cost with the object of reducing the serious risk of unintentional damage being caused to its cables and pipes. **Essential Energy does not accept any responsibility for any omissions, inaccuracies or errors in the plans, or any reliance place on the material. Any reliance placed on any plan provided in response to your request is at your own risk.**



Essential Energy retains all intellectual and industrial property rights which exists or may exist in or with respect to the plan(s). The material provided is not to be copied or distributed beyond you.

You release Essential Energy from and against all claims, demands, actions and proceedings arising out of or in any way related to the use of the provided material.

**Location of Assets on Site:**

The plans indicate only that cables and pipes may exist in the general vicinity – they do not pinpoint the exact location of the cables and pipes.

If it is found that the location of cables or pipes on the plans can be improved, please notify Essential Energy on 13 23 91 (or fax 1800 354 636).

All individuals have a duty of care they must observe when working in the vicinity of underground cables and pipes. It is the **excavator's responsibility to visually expose the underground cables and pipes manually, ie. by using hand-held tools and non-destructive pot-holing techniques prior to any mechanical excavation**. The excavator will be held responsible for all damage caused to the Essential Energy network or cables and pipes, and for the costs associated with the repair of any such damage. The excavator will also be held responsible for all damage caused to any persons.

When digging in the vicinity of underground assets, persons should observe the requirements of the applicable Codes of Practice published by the NSW Work Cover Authority or Safe Work Australia, and any amendments from time to time by the Authorities, including although not limited to:

- Excavation Work
- Managing Electrical Risks in the workplace
- How to manage and control asbestos in the workplace

(Please refer to <https://www.workcover.nsw.gov.au/law-and-policy/legislation-and-codes/codes-of-practice>).

When digging in the vicinity of **electrical assets** persons should observe the requirements of the **Electricity Supply Act 1995**.

Persons excavating near live underground electrical reticulation and/or earthing cables **must exercise extreme caution at all times and adhere to the requirements of Essential Energy's Electrical Safety Rules**. (These are available on our website: <http://www.essentialenergy.com.au/content/safety-community> and include

- **Work near Essential Energy's Underground Assets:**  
<http://www.essentialenergy.com.au/asset/cms/pdf/contestableWorks/CEOP8041.pdf> , and
- **Asbestos Fact Sheet:**  
<http://www.essentialenergy.com.au/asset/cms/pdf/safety/AsbestosFactSheet.pdf>

In some situations these procedures call for work to be performed by authorised staff.

Should there be any doubt as to the exact location of any underground electrical assets, and the potential for conflict with live underground cables caused by excavation at your work site, you should contact

**13 23 91** to arrange for an on-site visit by an Essential Energy representative. No construction or mechanical excavation work is to commence prior to this on-site visit and approval being obtained.

When digging in the vicinity of **water or sewer assets** persons should observe the requirements of the **Water Management Act 2000**.

Should there be any doubt as to the exact location of any underground water and sewer assets, and the potential for conflict with underground water and sewer pipes caused by excavation at your work site, you should contact **13 23 91** to arrange for an on-site visit. No construction or excavation work is to commence prior to this on-site visit and approval being obtained.

**Prior Notification:**

Please note that for excavation depths greater than 250mm near power poles and stays you should allow for **advance notice** in your construction program to permit Essential Energy time to allocate the necessary field resources to carry out the inspection at the site a **minimum of fourteen (14) working days prior to work commencing**. This service may incur a fee and this can be negotiated with the local Area Coordinator at the time of making the appointment. Failure to give reasonable notice to the local Area Coordinator may result in disruption to Essential Energy's planned works program in the district and could incur an extra charge over and above the normal rate for this service.

**For further information please call 13 23 91.**

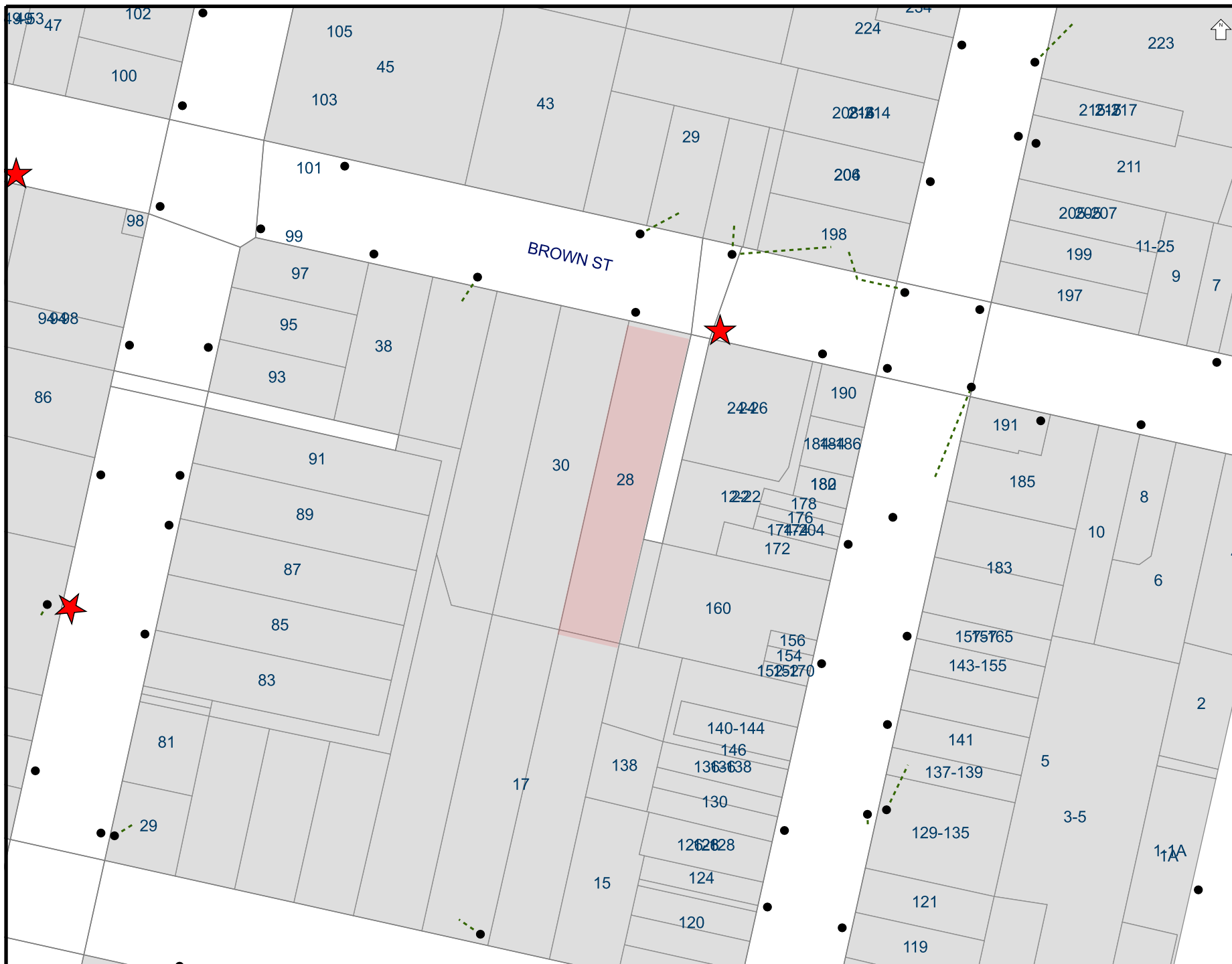

Overhead wires not shown  
LOOK UP & LIVE!

## LEGEND

- LV Underground Cable
- HV Underground Cable
- Underground Pipe
- Underground Earth or Wires
- Ground Substation
- Pole
- Cubicle
- Pit
- Area of Interest

## Critical Assets

Contact Essential Energy  
on 13 23 91

- Zone Substation
- Underground Cable
- Underground Fibre

## Proposed Works

- Area of proposed works

Proposed assets are shown as  
orange symbols

THE INFORMATION ON THIS  
MAP MAY NOT BE

ACCURATE.  
If details are  
incorrect, please  
notify

Essential Energy on  
13 23 91  
(or fax 1800 354 636)

ISSUE DATE: 16/12/2024

You must resubmit your  
request if you have not  
started work within 4 weeks  
of the 'Issue Date' above

A4 SCALE: 1:1586



Job Number: 38281273

Sequence number: 248801805

Job location: 28 Brown St, Dungog

Map  
Centre:

Referral

248801806

Member Phone

1300 657 657

Responses from this member

Response received Mon 16 Dec 2024 9.57am

File name	Page
Response Body	14
248801806.pdf	15
Legend.pdf	21

THIS IS AN AUTOMATED RESPONSE. PLEASE DO NOT RESPOND TO THIS EMAIL To: Laura Vallentine RE: Before You Dig Australia (BYDA) REFERRAL NOTIFICATION FROM HUNTER WATER CORPORATION NSW Sequence No: 248801806 Enquiry Date: 16/12/2024 Commencement Date: 01/03/2025 Completion Date: 01/03/2026 Thank you for the above enquiry. Please find attached the "248801806.pdf" which overviews your proposed work area in association with Hunter Water Corporation's assets. Please note that this communication, including any attachments, is confidential. If you are not the intended recipient, you should not read it please contact us immediately, destroy it, and do not copy or use any part of this communication.



# Before You Dig Australia (BYDA)

## Location Information

**Hunter Water Corporation**  
36 Honeysuckle Drive  
NEWCASTLE NSW 2300

**To:**  
Laura Vallentine Architect - Laura Vallentine  
36 Kestrel Avenue  
Salamander Bay                      NSW                      2317

Enquiry Details	
Utility ID	80220
Job Number	38281273
Sequence Number	248801806
Enquiry Date	16/12/2024 08:57
Response	<b>AFFECTED</b>
Address	28 Brown St Dungog
Location in Road	
Activity	Planning and Design

Enquirer Details	
Customer ID	3648544
Contact	Laura Vallentine
Company	Laura Vallentine Architect
Email	lauravallentine@gmail.com
Phone	+61401202615



# Overview Map

Sequence No: 248801806  
28 Brown St Dungog

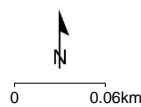
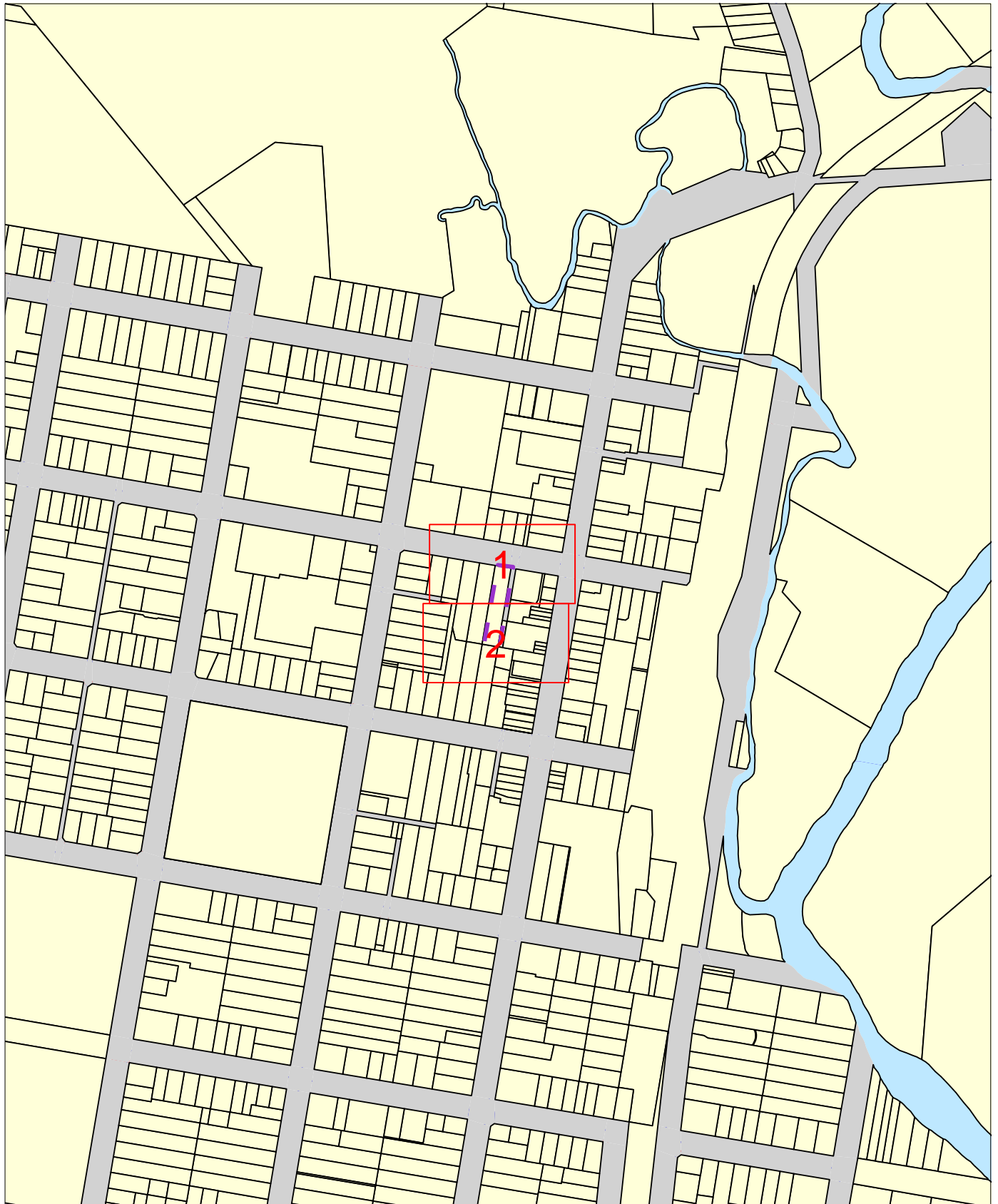

## LEGEND:

- 1** Detail Map
-  BYDADIA Work Area

## Map 1

**Sequence No: 248801806**

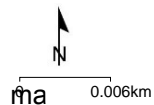
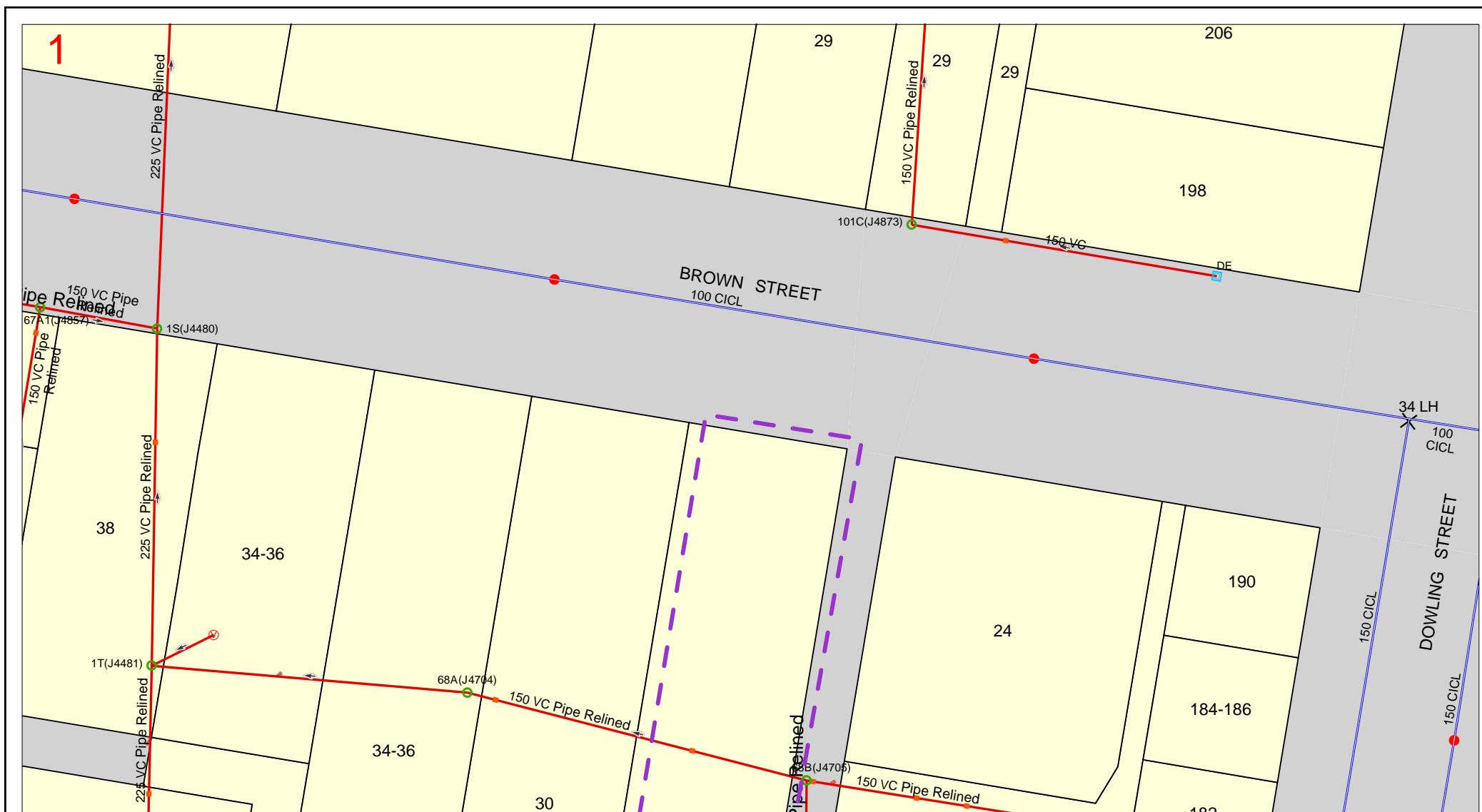

THIS PLAN IS NOT TO BE USED FOR CONVEYANCING

THIS INFORMATION IS VALID FOR 30 DAYS FROM THE DATE OF ISSUE

SEWER/WATER/RECYCLED WATER/  
ELECTRICAL - UTILITY DATA  
© HUNTER WATER CORPORATION 2019

SERVICE LOCATIONS ARE APPROXIMATE.  
HAND DIG UNTIL ACTUAL LOCATIONS ARE IDENTIFIED.  
PROPERTY SERVICES ARE NOT SHOWN.

ANY INFORMATION ON THIS PLAN MAY NOT BE UP TO DATE  
AND THE CORPORATION ACCEPTS NO RESPONSIBILITY FOR  
ITS ACCURACY.

CADASTRAL DATA © Department Finance, Services & Innovation  
[Nov 2017]



# Map 2

Sequence No: 248801806

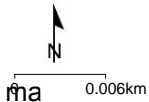
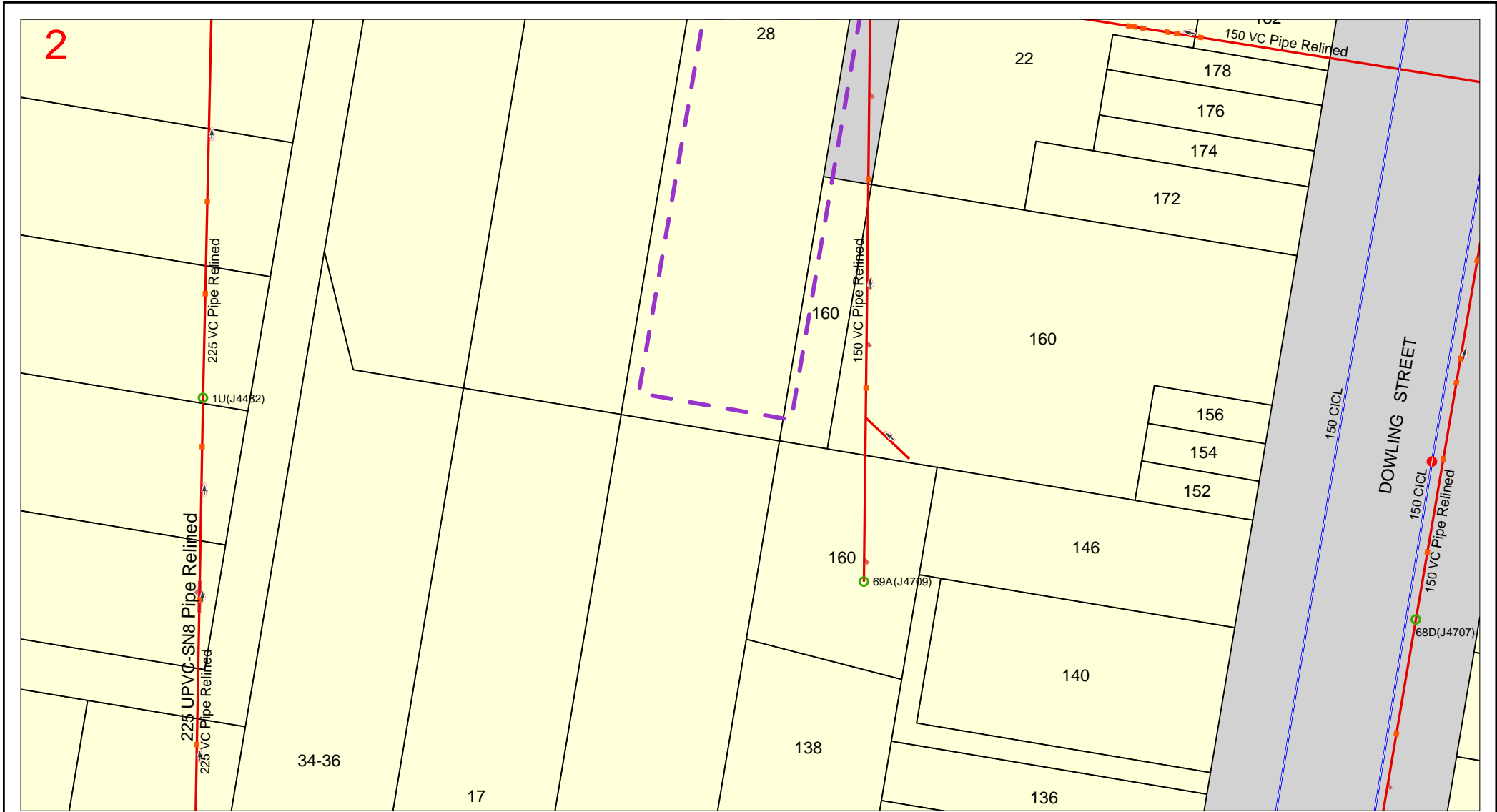

**IMPORTANT**

**THIS PLAN IS NOT TO BE USED FOR CONVEYANCING**

THIS INFORMATION IS VALID FOR 30 DAYS FROM THE DATE OF ISSUE

SEWER/WATER/RECYCLED WATER/  
ELECTRICAL - UTILITY DATA  
© HUNTER WATER CORPORATION 2019

SERVICE LOCATIONS ARE APPROXIMATE.  
HAND DIG UNTIL ACTUAL LOCATIONS ARE IDENTIFIED.  
PROPERTY SERVICES ARE NOT SHOWN.

ANY INFORMATION ON THIS PLAN MAY NOT BE UP TO DATE  
AND THE CORPORATION ACCEPTS NO RESPONSIBILITY FOR  
ITS ACCURACY.

CADASTRAL DATA © Department Finance, Services & Innovation  
[Nov 2017]

# Hunter Water Corporation DBYD Asset Legend

Electrical Assets	Water Assets		RecycledWater Assets	Sewer Assets	StormWater Assets	Land Details
 High Voltage	 Contol Valve	 HWC Rain Gauge	 Air Valve	 Air Valve	 StormWater Assets	 Area of Interest
 Low Voltage	 Hydrant Control Valve	 HWC Stream Flow Gauge	 Reflux Valve Open	 Stop/Butterfly/Ball Valve	 StormWater Network Structure	 Easement Non HWC
 Electrical Pole	 Reflux Valve	 Radio Base	 Stop Valve Open	 Gate Valve	 StormWater Mains	 Fence Line
 Distribution Transformer	 Stop/Scour Valve	 Weather Station	 RecycledWater Hydrant	 Manhole	 Mains Abandon	 Non-HWC Easement
 Air Break Switch	 Tee & Stop Valve	 Piezometer	 Cluster Box	 Cap		 HWC Easement
 Circuit Breaker	 Hydrant	 Bore Site	 End Cap	 Dead End		 Parcel
 High Voltage	 Cluster Box		 Flushing Tap	 Flushing Tank		 Road
 Low Voltage	 End Cap		 Manhole	 H&V Bend		 Water Parcels
	 Flushing Tap		 Scour	 Junction Connection		 Hazardous Material
	 Manhole		 RecycledWater Meter	 Outfall		 Map Sheet Index
	 Scour		 RecycledWater Network Structure	 Overflow		
	 Water Meter		 Other Main	 Sewer/Valve Pit		
	 Water Network Structure		 Reticulation Main	 Tangent Point		
	 Other Main		 Reticulation Main Encased/Conduit	 Sewer Meter		
	 Trunk Main		 Trunk Main	 Sewer Vent		
	 Reticulation Main		 Trunk Main Encased/Conduit	 Sewer Network Structure		
	 Water Encased Mains		 RecycledWater Encased Mains	 Other Main		
	 Water Prelaid Service		 RecycledWater Prelaid Service	 Gravity Main		
				 Pressure/Vacuum Main		
				 Effluent Main		
				 Outfall		
				 Overflow Main		
				 Rising Main		
				 Sewer Encased Mains		

Referral  
248801804

Member Phone  
1800 687 626

Responses from this member

Response received Mon 16 Dec 2024 10.51am

File name	Page
Response Body	23
248801804_20241215_235036679725_pwc_1.pdf	24
248801804_20241215_235036679725_1.pdf	27
Disclaimer_248801804_20241215_235036679725.pdf	30
4678_NBN_Dial_Before_You_Dig_Poster_20170517.pdf	34

Hi Laura Vallentine,

Please find attached the response to your DBYD referral for the address mentioned in the subject line. The location shown in our DBYD response is assumed based off the information you have provided. If the location shown is different to the location of the excavation then this response will consequently be rendered invalid.

Take the time to read the response carefully and note that this information is only valid for 28 days after the date of issue.

If you have any further enquiries, please do not hesitate to contact us.

Regards,  
Network Services and Operations  
NBN Co Limited  
P: 1800626329  
E: [dbyd@nbnco.com.au](mailto:dbyd@nbnco.com.au)  
[www.nbnco.com.au](http://www.nbnco.com.au)

#### Confidentiality and Privilege Notice

This e-mail is intended only to be read or used by the addressee. It is confidential and may contain legally privileged information. If you are not the addressee indicated in this message (or responsible for delivery of the message to such person), you may not copy or deliver this message to anyone, and you should destroy this message and kindly notify the sender by reply e-mail. Confidentiality and legal privilege are not waived or lost by reason of mistaken delivery to you. Any views expressed in this message are those of the individual sender, except where the sender specifically states them to be the views of NBN Co Limited

Please Do Not Reply To This Mail

**To:** Laura Vallentine  
**Phone:** Not Supplied  
**Fax:** Not Supplied  
**Email:** lauravallentine@gmail.com

<b>Dial before you dig Job #:</b>	38281273	
<b>Sequence #</b>	248801804	
<b>Issue Date:</b>	15/12/2024	
<b>Location:</b>	28 Brown St , Dungog , NSW , 2420	

Indicative Plans are tiled below to demonstrate how to layout and read nbn asset plans

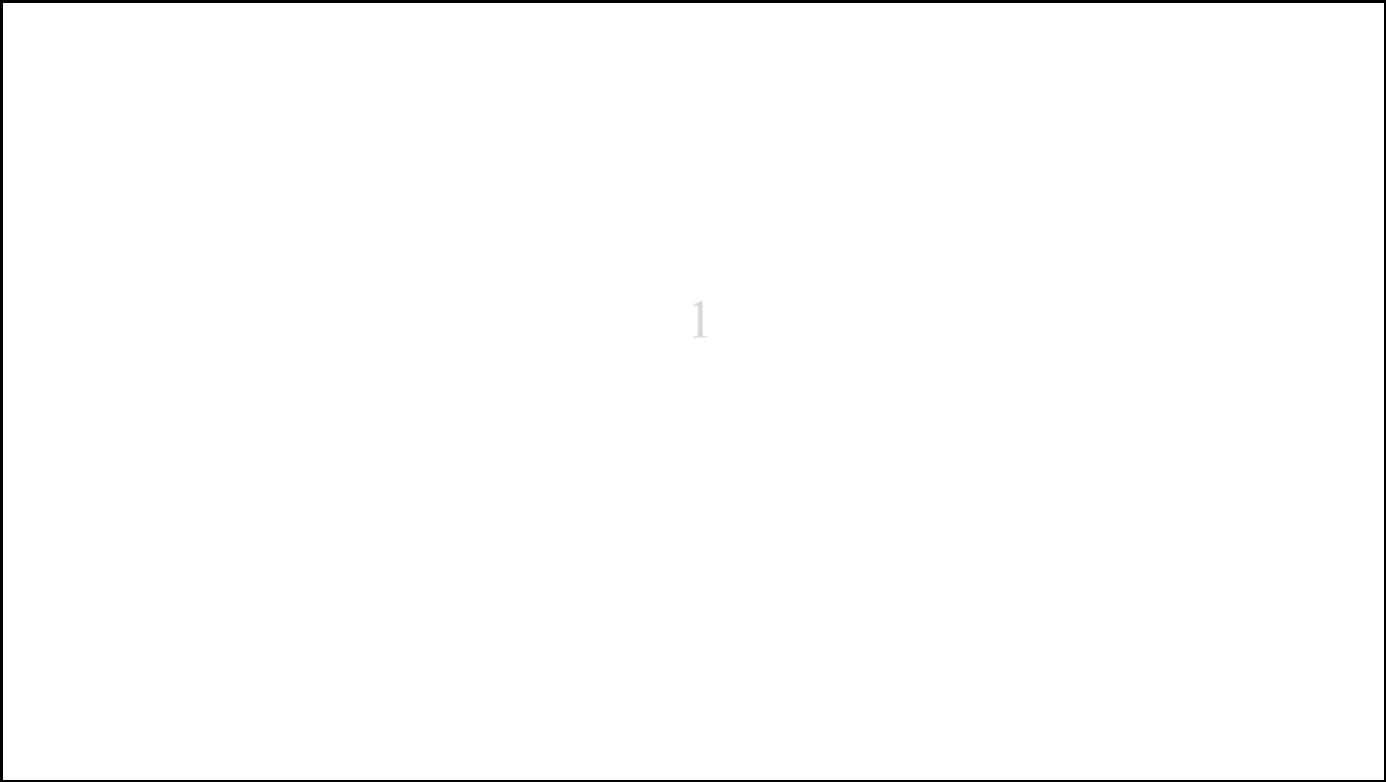



## LEGEND



	Parcel and the location
	Pit with size "5"
	Power Pit with size "2E". Valid PIT Size: e.g. 2E, 5E, 6E, 8E, 9E, E, null.
	Manhole
	Pillar
	Cable count of trench is 2. One "Other size" PVC conduit (PO) owned by Telstra (-T-), between pits of sizes, "5" and "9" are 25.0m apart. One 40mm PVC conduit (P40) owned by NBN, between pits of sizes, "5" and "9" are 20.0m apart.
	2 Direct buried cables between pits of sizes, "5" and "9" are 10.0m apart.
	Trench containing any <b>INSERVICE/CONSTRUCTED</b> (Copper/RF/Fibre) cables.
	Trench containing only <b>DESIGNED/PLANNED</b> (Copper/RF/Fibre/Power) cables.
	Trench containing any <b>INSERVICE/CONSTRUCTED</b> (Power) cables.
	Road and the street name "Broadway ST"
Scale	0 20 40 60 Meters 1:2000  1 cm equals 20 m

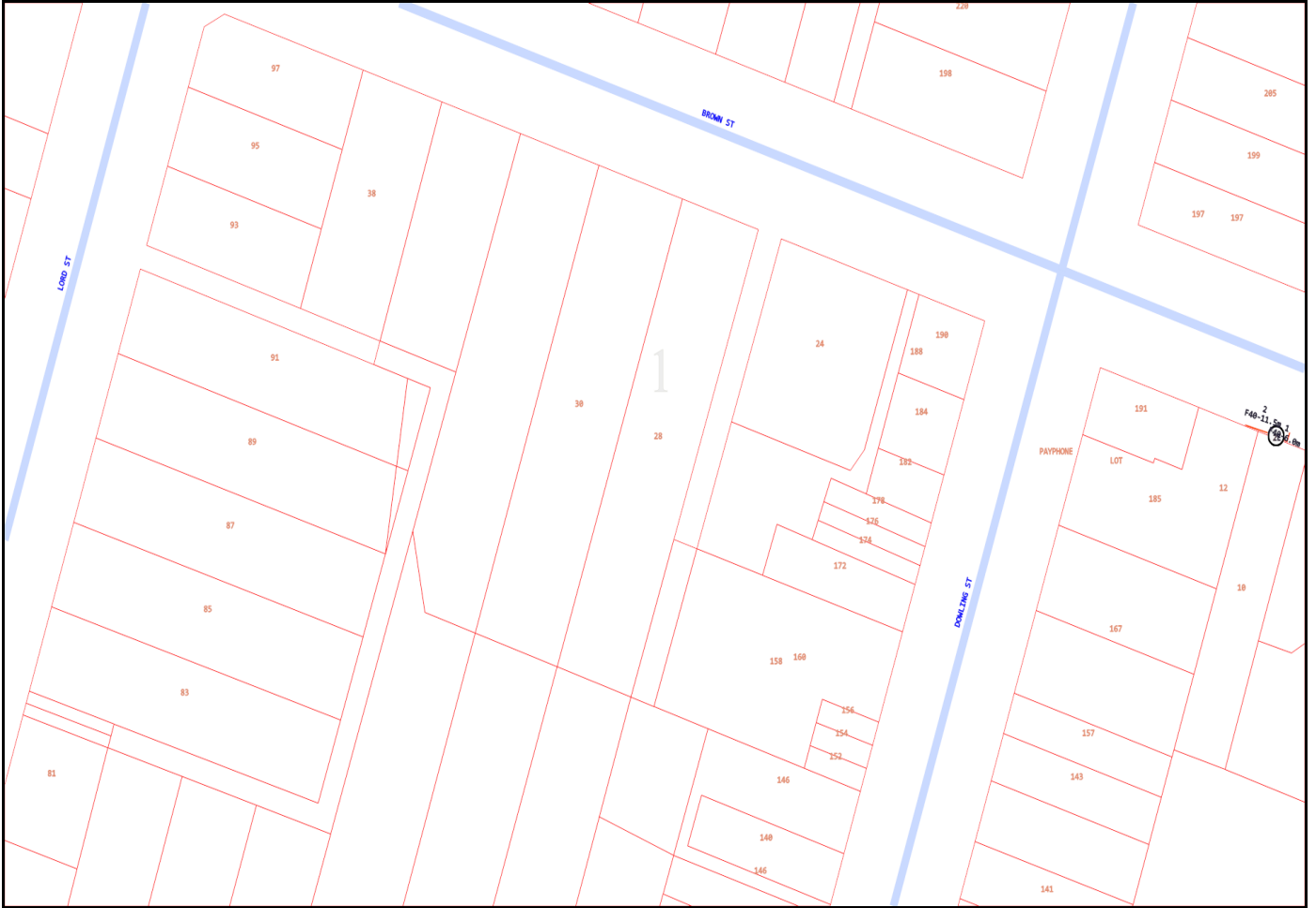

## Emergency Contacts

You must immediately report any damage to the **nbn™** network that you are/become aware of. Notification may be by telephone - 1800 626 329.

**To:** Laura Vallentine  
**Phone:** Not Supplied  
**Fax:** Not Supplied  
**Email:** lauravallentine@gmail.com

<b>Dial before you dig Job #:</b>	38281273	
<b>Sequence #</b>	248801804	
<b>Issue Date:</b>	15/12/2024	
<b>Location:</b>	28 Brown St , Dungog , NSW , 2420	

Indicative Plans are tiled below to demonstrate how to layout and read nbn asset plans

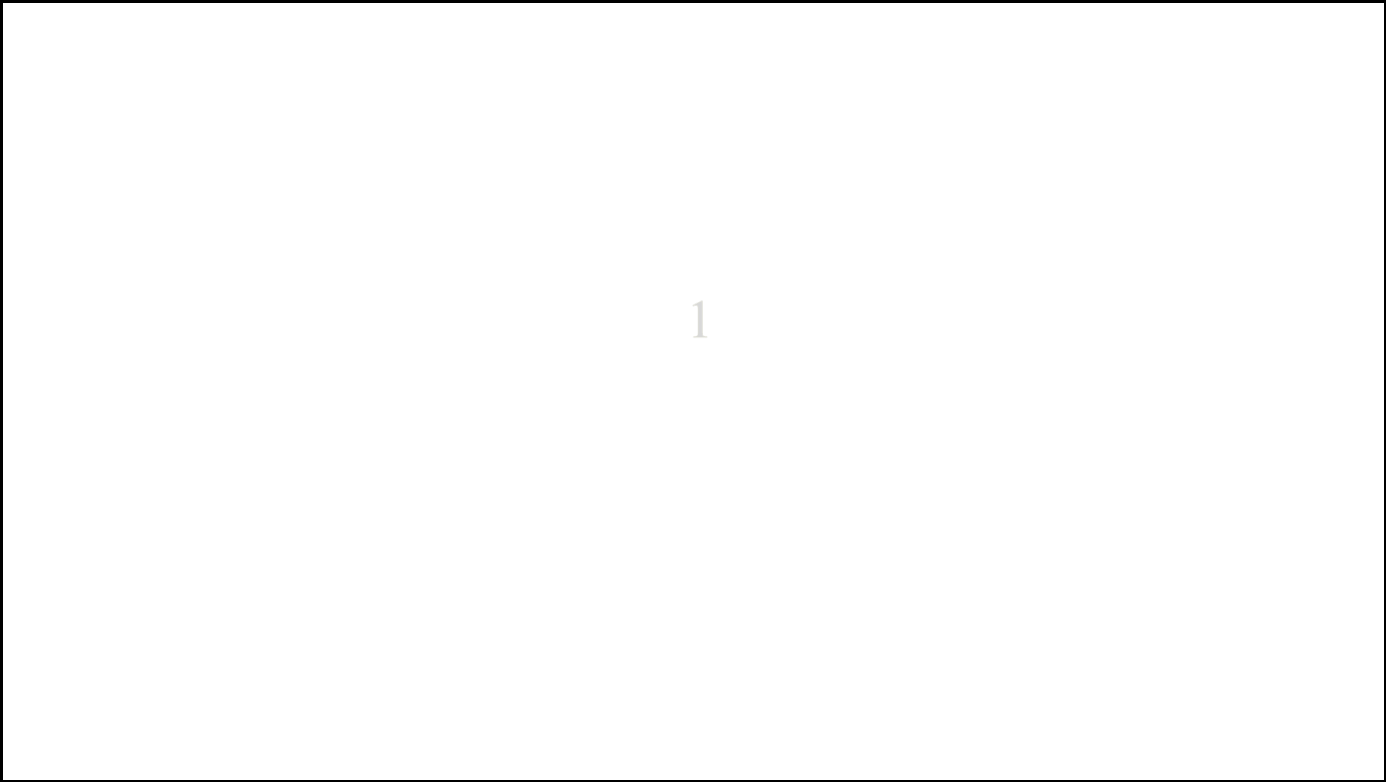



## LEGEND



	Parcel and the location
	Pit with size "5"
	Power Pit with size "2E". Valid PIT Size: e.g. 2E, 5E, 6E, 8E, 9E, E, null.
	Manhole
	Pillar
	Cable count of trench is 2. One "Other size" PVC conduit (PO) owned by Telstra (-T-), between pits of sizes, "5" and "9" are 25.0m apart. One 40mm PVC conduit (P40) owned by NBN, between pits of sizes, "5" and "9" are 20.0m apart.
	2 Direct buried cables between pits of sizes, "5" and "9" are 10.0m apart.
	Trench containing any <b>INSERVICE/CONSTRUCTED</b> (Copper/RF/Fibre) cables.
	Trench containing only <b>DESIGNED/PLANNED</b> (Copper/RF/Fibre/Power) cables.
	Trench containing any <b>INSERVICE/CONSTRUCTED</b> (Power) cables.
	Road and the street name "Broadway ST"
Scale	0 20 40 60 Meters 1:2000  1 cm equals 20 m



**To:** Laura Vallentine  
**Phone:** Not Supplied  
**Fax:** Not Supplied  
**Email:** lauravallentine@gmail.com

<b>Before You Dig Australia Job #:</b>	38281273	 <b>BEFORE YOU DIG</b> www.byda.com.au Zero Damage - Zero Harm
<b>Sequence #</b>	248801804	
<b>Issue Date:</b>	15/12/2024	
<b>Location:</b>	28 Brown St , Dungog , NSW , 2420	

## Information

The area of interest requested by you contains one or more assets.

<b>nbn™ Assets</b>	<b>Search Results</b>
<b>Communications</b>	Asset identified
<b>Electricity</b>	Asset identified

In this notice **nbn™ Facilities** means *underground fibre optic, telecommunications and/or power facilities, including but not limited to cables, owned and controlled by nbn™*

## Location of nbn™ Underground Assets

We thank you for your enquiry. In relation to your enquiry at the above address:

- **nbn's** records indicate that there **ARE nbn™** Facilities in the vicinity of the location identified above ("Location").
- **nbn** indicative plan/s are attached with this notice ("Indicative Plans").
- The Indicative Plan/s show general depth and alignment information only and are not an exact, scale or accurate depiction of the location, depth and alignment of **nbn™** Facilities shown on the Plan/s.
- In particular, the fact that the Indicative Plans show that a facility is installed in a straight line, or at uniform depth along its length cannot be relied upon as evidence that the facility is, in fact, installed in a straight line or at uniform depth.
- You should read the Indicative Plans in conjunction with this notice and in particular, the notes below.
- You should note that, at the present time, the Indicative Plans are likely to be more accurate in showing location of fibre optics and telecommunications cables than power cables. There may be a variation between the line depicted on the Indicative Plans and the location of any power cables. As such, consistent with the notes below, particular care must be taken by you to make your own enquiries and investigations to precisely locate any power cables and manage the risk arising from such cables accordingly.
- The information contained in the Indicative Plan/s is valid for 28 days from the date of issue set out above. You are expected to make your own inquiries and perform your own investigations (including engaging appropriately qualified plant locators, e.g BYDA Certified Locators, at your cost to locate **nbn™** Facilities during any activities you carry out on site).

We thank you for your enquiry and appreciate your continued use of the Before You Dig Australia Service. For any enquiries related to moving assets or Planning and Design activities, please visit the **nbn Commercial Works** website to complete the online application form. If you are planning to excavate and require further information, please email [dbyd@nbnco.com.au](mailto:dbyd@nbnco.com.au) or call 1800 626 329.

#### Notes:

1. You are now aware that there are **nbn™** Facilities in the vicinity of the above property that could be damaged as a result activities carried out (or proposed to be carried out) by you in the vicinity of the Location.
2. You should have regard to section 474.6 and 474.7 of the *Criminal Code Act 1995* (CoA) which deals with the consequences of interfering or tampering with a telecommunications facility. Only persons authorised by **nbn** can interact with **nbn's** network facilities.
3. Any information provided is valid only for **28 days** from the date of issue set out above.

## Referral Conditions

The following are conditions on which **nbn** provides you with the Indicative Plans. By accepting the plans, you are agreeing to these conditions. These conditions are in addition, and not in replacement of, any duties and obligations you have under applicable law.

1. **nbn** does not accept any responsibility for any inaccuracies of its plans including the Indicative Plans. You are expected to make your own inquiries and perform your own investigations (including engaging appropriately qualified plant locators, e.g BYDA Certified Locators, at your cost to locate **nbn™** Facilities during any activities you carry out on site).
2. You acknowledge that **nbn** has specifically notified you above that the Indicative Plans are likely to be more accurate in showing location of fibre optics and telecommunications cables than power cables. There may be a variation between the line depicted on the Indicative Plans and the location of any power cables.
3. You should not assume that **nbn™** Facilities follow straight lines or are installed at uniform depths

along their lengths, even if they are indicated on plans provided to you. Careful onsite investigations are essential to locate the exact position of cables.

4. In carrying out any works in the vicinity of **nbn**™ Facilities, you must maintain the following minimum clearances:
  - 300mm when laying assets inline, horizontally or vertically.
  - 500mm when operating vibrating equipment, for example: jackhammers or vibrating plates.
  - 1000mm when operating mechanical excavators.
  - Adherence to clearances as directed by other asset owner's instructions and take into account any uncertainty for power cables.
5. You are aware that there are inherent risks and dangers associated with carrying out work in the vicinity of underground facilities (such as **nbn**™ fibre optic, copper and coaxial cables, and power cable feed to **nbn**™ assets). Damage to underground electric cables may result in:
  - Injury from electric shock or severe burns, with the possibility of death.
  - Interruption of the electricity supply to wide areas of the city.
  - Damage to your excavating plant.
  - Responsibility for the cost of repairs.
6. You must take all reasonable precautions to avoid damaging **nbn**™ Facilities. These precautions may include but not limited to the following:
  - All excavation sites should be examined for underground cables by careful hand excavation. Cable cover slabs if present must not be disturbed. Hand excavation needs to be undertaken with extreme care to minimise the likelihood of damage to the cable, for example: the blades of hand equipment should be aligned parallel to the line of the cable rather than digging across the cable.
  - If any undisclosed underground cables are located, notify **nbn** immediately.
  - All personnel must be properly briefed, particularly those associated with the use of earth-moving equipment, trenching, boring and pneumatic equipment.
  - The safety of the public and other workers must be ensured.
  - All excavations must be undertaken in accordance with all relevant legislation and regulations.
7. You will be responsible for all damage to **nbn**™ Facilities that are connected whether directly, or indirectly with work you carry out (or work that is carried out for you or on your behalf) at the Location. This will include, without limitation, all losses expenses incurred by **nbn** as a result of any such damage.
8. You must immediately report any damage to the **nbn**™ network that you are/become aware of. Notification may be by telephone - 1800 626 329.
9. Except to the extent that liability may not be capable of lawful exclusion, **nbn** and its servants and agents and the related bodies corporate of **nbn** and their servants and agents shall be under no liability whatsoever to any person for any loss or damage (including indirect or consequential loss or damage) however caused (including, without limitation, breach of contract negligence and/or breach of statute) which may be suffered or incurred from or in connection with this information sheet or any plans (including Indicative Plans) attached hereto. Except as expressly provided to the contrary in this information sheet or the attached plans (including Indicative Plans), all terms, conditions, warranties, undertakings or representations (whether expressed or implied) are excluded to the fullest extent permitted by law.

All works undertaken shall be in accordance with all relevant legislations, acts and regulations applicable to the particular state or territory of the Location. The following table lists all relevant documents that shall be considered and adhered to.

State/Territory	Documents
National	Work Health and Safety Act 2011
	Work Health and Safety Regulations 2011
	Safe Work Australia - Working in the Vicinity of Overhead and Underground Electric Lines (Draft)

	Occupational Health and Safety Act 1991
<b>NSW</b>	Electricity Supply Act 1995
	Work Cover NSW - Work Near Underground Assets Guide
	Work Cover NSW - Excavation Work: Code of Practice
<b>VIC</b>	Electricity Safety Act 1998
	Electricity Safety (Network Asset) Regulations 1999
<b>QLD</b>	Electrical Safety Act 2002
	Code of Practice for Working Near Exposed Live Parts
<b>SA</b>	Electricity Act 1996
<b>TAS</b>	Tasmanian Electricity Supply Industry Act 1995
<b>WA</b>	Electricity Act 1945
	Electricity Regulations 1947
<b>NT</b>	Electricity Reform Act 2005
	Electricity Reform (Safety and Technical) Regulations 2005
<b>ACT</b>	Electricity Act 1971

Thank You,

**nbn BYDA**

Date: 15/12/2024

This document is provided for information purposes only. This document is subject to the information classification set out on this page. If no information classification has been included, this document must be treated as UNCLASSIFIED, SENSITIVE and must not be disclosed other than with the consent of nbn co. The recipient (including third parties) must make and rely on their own inquiries as to the currency, accuracy and completeness of the information contained herein and must not use this document other than with the consent of nbn co.

Copyright © 2021 nbn co Limited. All rights reserved.

Referral

248801807

Member Phone

1800 653 935

Responses from this member

Response received Mon 16 Dec 2024 12.57pm

File name	Page
Response Body	37
Telstra Duty of Care v32.0b.pdf	38
248801807.pdf	40
Telstra Map Legend 4.0b.pdf	42
AccreditedPlantLocators 2024-09-13a.pdf	43

**Attention:** Laura Vallentine

**Site Location:** 28 Brown St, Dungog, NSW 2420

**Your Job Reference:** 24\_001\_28 Brown ST

**Please do not reply to this email, this is an automated message -**

Thank you for requesting Telstra information via Before You Dig Australia (BYDA).

This response contains Telstra information relating to your recent BYDA request.

Information for opening Telstra Asset Plans as well as some other useful contact information is listed in the attached **Telstra Map Legend** **attached**.

**Please refer to all enclosed attachments for more information.**

**Please Report Damage to Telstra Equipment:** [Report damages to Telstra equipment - Telstra](#)

Please note:

When working in the vicinity of telecommunications plant you have a 'Duty of Care' that must be observed.

Please ensure you read the 'Telstra Duty of Care' document (attached) - it contains important information including essential steps that must be undertaken prior to commencing construction activities.

**WARNING - MAJOR CABLES and/or OPTIC FIBRE IN THE AREA.**

**Phone 1800 653 935 for further assistance.**

Note: In some areas Telstra fibre routes may be marked as "Amcom", as Telstra has purchased much of this infrastructure. If in doubt, please contact Telstra Plan services on the number above. Telstra plans and information are only valid for 60 days from the date of issue.

**WARNING:**

Telstra plans and location information conform to Quality Level 'D' of the Australian Standard AS 5488 - Classification of Subsurface Utility Information. As such, Telstra supplied location information is indicative only. Spatial accuracy is not applicable to Quality Level D. Refer to AS 5488 for further details. The exact position of Telstra assets can only be validated by physically exposing them. Telstra does not warrant or hold out that its plans are accurate and accepts no responsibility for any inaccuracy. Further on site investigation is required to validate the exact location of Telstra assets prior to commencing work. A Certified Locating Organisation is an essential part of the process to validate the exact location of Telstra assets and to ensure the assets are protected during construction works. See the [Steps - Working Near Telecommunications Assets \(attached Telstra Duty of Care\)](#).

Please note that:

- it is a criminal offence under the *Criminal Code Act 1995* (Cth) to tamper or interfere with telecommunications infrastructure.
- Telstra will take action to recover compensation for damage caused to property and assets, and for interference with the operation of Telstra's networks and customers' services.

Telstra's plans contain Telstra's confidential information and are provided on the basis that they are used solely for identifying the location or vicinity of Telstra's infrastructure to avoid damage to this infrastructure occurring as part of any digging or other excavation activity. You must not use Telstra's plans for any other purpose or in a way that will cause Telstra loss or damage and you must comply with any other terms of access to the data that have been provided to you by Telstra (including Conditions of Use or Access).

*(See attached file: Telstra Duty of Care v32.0b.pdf)*

*(See attached file: Telstra Map Legend 4.0b.pdf)*

*(See attached file: AccreditedPlantLocators 2024-09-13a.pdf)*

*(See attached file: 248801807.pdf)*

**Cable Plan**

The diagram illustrates a complex cable network for a residential area. Key features include:

- Streets:** Lord Brown, Lord ST, Lord DOWLING, and various numbered streets (e.g., 1, 3, 5, 7, 9, 11, 13, 15, 17, 19, 21, 23, 25, 27, 29, 31, 33, 35, 37, 39, 41, 43, 45, 47, 49, 51, 53, 55, 57, 59, 61, 63, 65, 67, 69, 71, 73, 75, 77, 79, 81, 83, 85, 87, 89, 91, 93, 95, 97, 99, 101, 103, 105, 107, 109, 111, 113, 115, 117, 119, 121, 123, 125, 127, 129, 131, 133, 135, 137, 139, 141, 143, 145, 147, 149, 151, 153, 155, 157, 159, 161, 163, 165, 167, 169, 171, 173, 175, 177, 179, 181, 183, 185, 187, 189, 191, 193, 195, 197, 199, 201, 203, 205, 207, 209, 211, 213, 215, 217, 219, 221, 223, 225, 227, 229, 231, 233, 235, 237, 239, 241, 243, 245, 247, 249, 251, 253, 255, 257, 259, 261, 263, 265, 267, 269, 271, 273, 275, 277, 279, 281, 283, 285, 287, 289, 291, 293, 295, 297, 299, 301, 303, 305, 307, 309, 311, 313, 315, 317, 319, 321, 323, 325, 327, 329, 331, 333, 335, 337, 339, 341, 343, 345, 347, 349, 351, 353, 355, 357, 359, 361, 363, 365, 367, 369, 371, 373, 375, 377, 379, 381, 383, 385, 387, 389, 391, 393, 395, 397, 399, 401, 403, 405, 407, 409, 411, 413, 415, 417, 419, 421, 423, 425, 427, 429, 431, 433, 435, 437, 439, 441, 443, 445, 447, 449, 451, 453, 455, 457, 459, 461, 463, 465, 467, 469, 471, 473, 475, 477, 479, 481, 483, 485, 487, 489, 491, 493, 495, 497, 499, 501, 503, 505, 507, 509, 511, 513, 515, 517, 519, 521, 523, 525, 527, 529, 531, 533, 535, 537, 539, 541, 543, 545, 547, 549, 551, 553, 555, 557, 559, 561, 563, 565, 567, 569, 571, 573, 575, 577, 579, 581, 583, 585, 587, 589, 591, 593, 595, 597, 599, 601, 603, 605, 607, 609, 611, 613, 615, 617, 619, 621, 623, 625, 627, 629, 631, 633, 635, 637, 639, 641, 643, 645, 647, 649, 651, 653, 655, 657, 659, 661, 663, 665, 667, 669, 671, 673, 675, 677, 679, 681, 683, 685, 687, 689, 691, 693, 695, 697, 699, 701, 703, 705, 707, 709, 711, 713, 715, 717, 719, 721, 723, 725, 727, 729, 731, 733, 735, 737, 739, 741, 743, 745, 747, 749, 751, 753, 755, 757, 759, 761, 763, 765, 767, 769, 771, 773, 775, 777, 779, 781, 783, 785, 787, 789, 791, 793, 795, 797, 799, 801, 803, 805, 807, 809, 811, 813, 815, 817, 819, 821, 823, 825, 827, 829, 831, 833, 835, 837, 839, 841, 843, 845, 847, 849, 851, 853, 855, 857, 859, 861, 863, 865, 867, 869, 871, 873, 875, 877, 879, 881, 883, 885, 887, 889, 891, 893, 895, 897, 899, 901, 903, 905, 907, 909, 911, 913, 915, 917, 919, 921, 923, 925, 927, 929, 931, 933, 935, 937, 939, 941, 943, 945, 947, 949, 951, 953, 955, 957, 959, 961, 963, 965, 967, 969, 971, 973, 975, 977, 979, 981, 983, 985, 987, 989, 991, 993, 995, 997, 999, 1001, 1003, 1005, 1007, 1009, 1011, 1013, 1015, 1017, 1019, 1021, 1023, 1025, 1027, 1029, 1031, 1033, 1035, 1037, 1039, 1041, 1043, 1045, 1047, 1049, 1051, 1053, 1055, 1057, 1059, 1061, 1063, 1065, 1067, 1069, 1071, 1073, 1075, 1077, 1079, 1081, 1083, 1085, 1087, 1089, 1091, 1093, 1095, 1097, 1099, 1101, 1103, 1105, 1107, 1109, 1111, 1113, 1115, 1117, 1119, 1121, 1123, 1125, 1127, 1129, 1131, 1133, 1135, 1137, 1139, 1141, 1143, 1145, 1147, 1149, 1151, 1153, 1155, 1157, 1159, 1161, 1163, 1165, 1167, 1169, 1171, 1173, 1175, 1177, 1179, 1181, 1183, 1185, 1187, 1189, 1191, 1193, 1195, 1197, 1199, 1201, 1203, 1205, 1207, 1209, 1211, 1213, 1215, 1217, 1219, 1221, 1223, 1225, 1227, 1229, 1231, 1233, 1235, 1237, 1239, 1241, 1243, 1245, 1247, 1249, 1251, 1253, 1255, 1257, 1259, 1261, 1263, 1265, 1267, 1269, 1271, 1273, 1275, 1277, 1279, 1281, 1283, 1285, 1287, 1289, 1291, 1293, 1295, 1297, 1299, 1301, 1303, 1305, 1307, 1309, 1311, 1313, 1315, 1317, 1319, 1321, 1323, 1325, 1327, 1329, 1331, 1333, 1335, 1337, 1339, 1341, 1343, 1345, 1347, 1349, 1351, 1353, 1355, 1357, 1359, 1361, 1363, 1365, 1367, 1369, 1371, 1373, 1375, 1377, 1379, 1381, 1383, 1385, 1387, 1389, 1391, 1393, 1395, 1397, 1399, 1401, 1403, 1405, 1407, 1409, 1411, 1413, 1415, 1417, 1419, 1421, 1423, 1425, 1427, 1429, 1431, 1433, 1435, 1437, 1439, 1441, 1443, 1445, 1447, 1449, 1451, 1453, 1455, 1457, 1459, 1461, 1463, 1465, 1467, 1469, 1471, 1473, 1475, 1477, 1479, 1481, 1483, 1485, 1487,





Generated On 16/12/2024 12:51:26

**CAUTION:** Fibre optic and/ or major network present in plot area. Please read the Duty of Care and contact Telstra Plan Services should you require any assistance.

**WARNING**  
Telstra plans and location information conform to Quality Level "D" of the Australian Standard AS 5488-Classification of Subsurface Utility Information. As such, Telstra supplied location information is indicative only. Spatial accuracy is not applicable to Quality Level D. Refer to AS 5488 for further details. The exact position of Telstra assets can only be validated by physically exposing it. Telstra does not warrant or hold out that its plans are accurate and accepts no responsibility for any inaccuracy. Further on site investigation is required to validate the exact location of Telstra plant prior to commencing construction work. A Certified Locating Organisation is an essential part of the process to validate the exact location of Telstra assets and to ensure the asset is protected during construction works.

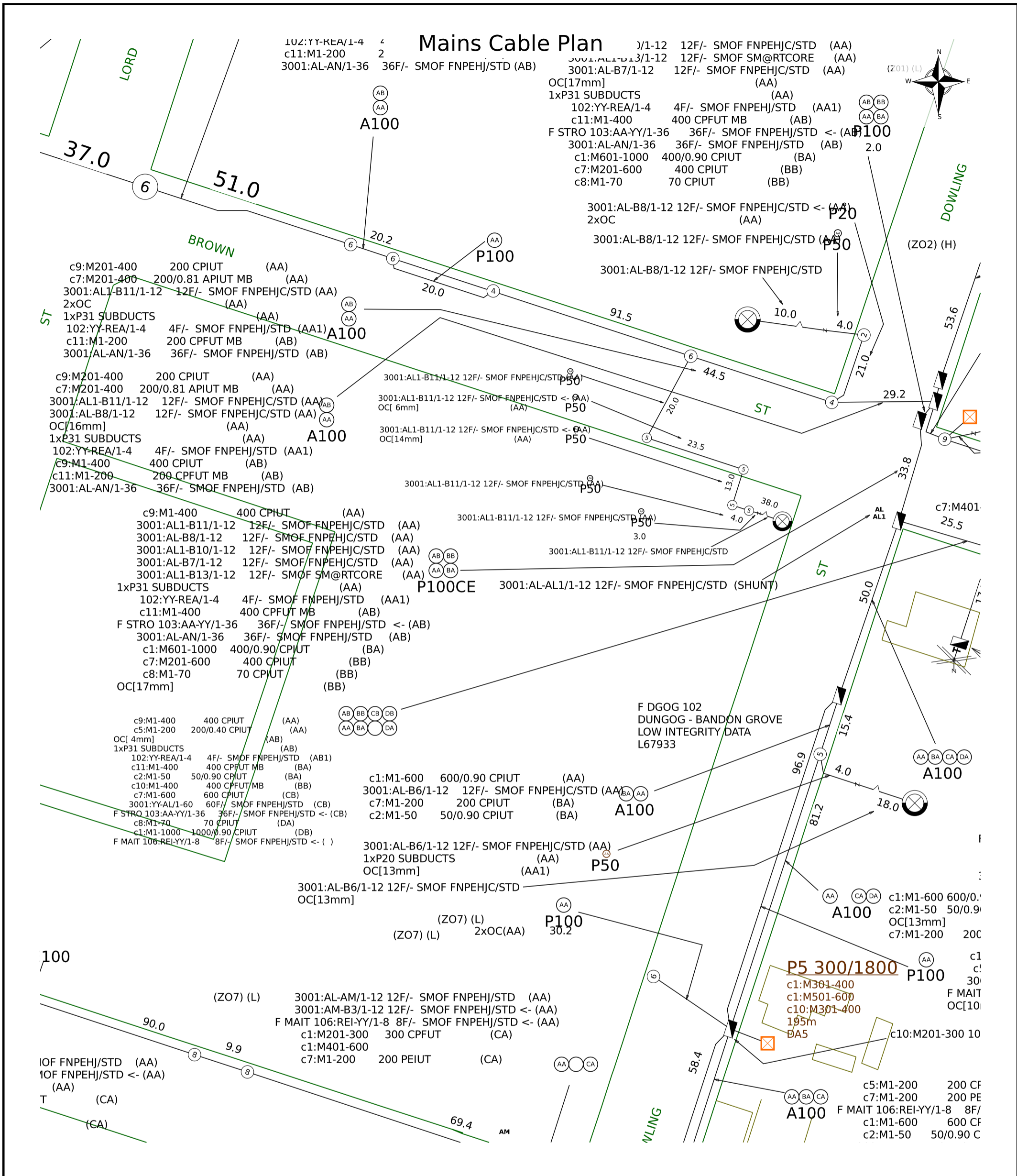
Page 1 of 2





Report Damage <https://service.telstra.com.au/customer/general/forms/report-damage-to-telstra/>  
Ph - 13 22 03  
Email - Telstra.Plans@team.telstra.com  
Planned Services - ph 1800 653 935 (AEST bus hrs only) General Enquiries

Sequence Number: 248801807

**CAUTION: Fibre optic and/ or major network present in plot area. Please read the Duty of Care and contact Telstra Plan Services should you require any assistance.**

TELSTRA LIMITED A.C.N. 086 174 781

Generated On 16/12/2024 12:51:32

The above plan must be viewed in conjunction with the Mains Cable Plan on the following page

**WARNING**  
Telstra plans and location information conform to Quality Level "D" of the Australian Standard AS 5488-Classification of Subsurface Utility Information. As such, Telstra supplied location information is indicative only. Spatial accuracy is not applicable to Quality Level D. Refer to AS 5488 for further details. The exact position of Telstra assets can only be validated by physically exposing it. Telstra does not warrant or hold out that its plans are accurate and accepts no responsibility for any inaccuracy. Further on site investigation is required to validate the exact location of Telstra plant prior to commencing construction work. A Certified Locating Organisation is an essential part of the process to validate the exact location of Telstra assets and to ensure the asset is protected during construction works.

See the Steps- Telstra Duty of Care that was provided in the email response.

## LEGEND

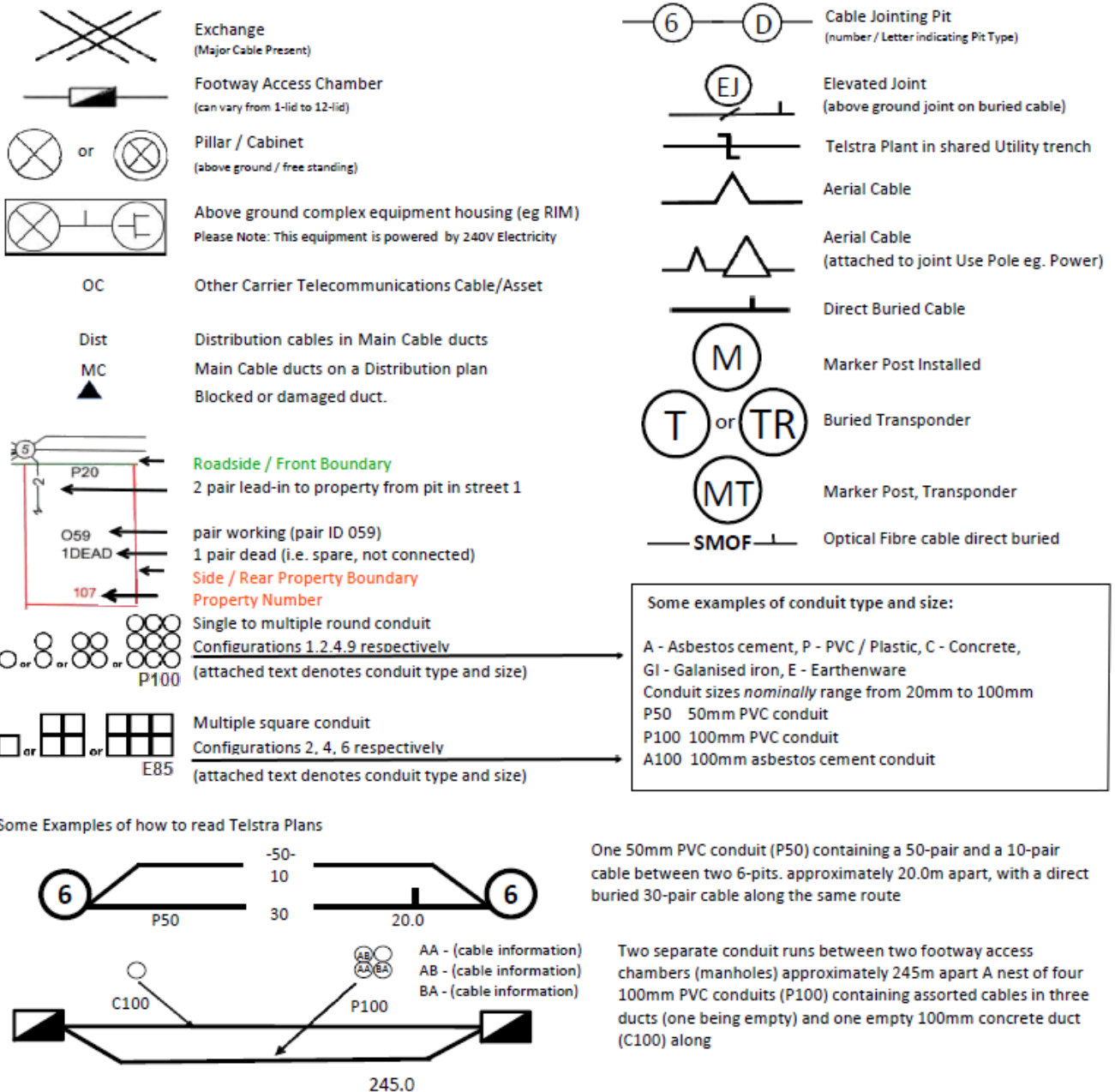

### Protect our Network:

by maintaining the following distances from our assets:

- 1.0m Mechanical Excavators, Farm Ploughing, Tree Removal
- 500mm Vibrating Plate or Wacker Packer Compactor
- 600mm Heavy Vehicle Traffic (over 3 tonnes) not to be driven across Telstra ducts or plant.
- 1.0m Jackhammers/Pneumatic Breakers
- 2.0m Boring Equipment (in-line, horizontal and vertical)

For more info contact a [CERTLOC Certified Locating Organisation \(CLO\)](#) or  
Telstra Location Intelligence Team 1800 653 935

## OPENING ELECTRONIC MAP ATTACHMENTS –

Telstra Cable Plans are generated automatically in either PDF or DWF file types.  
Dependent on the site address and the size of area selected.  
You may need to download and install free viewing software from the internet e.g.



DWF Map Files (all sizes over A3)  
Autodesk Viewer (Internet Browser) <https://viewer.autodesk.com/> or  
Autodesk Design Review <http://usa.autodesk.com/design-review/> for  
DWF files. (Windows PC)



PDF Map Files (max size A3)  
Adobe Acrobat Reader <http://get.adobe.com/reader/>



Telstra BYDA map related enquiries email  
[Telstra.Plans@team.telstra.com](mailto:Telstra.Plans@team.telstra.com)  
1800 653 935 (AEST Business Hours only)



REPORT ANY DAMAGE TO THE TELSTRA NETWORK IMMEDIATELY  
Report online - <https://www.telstra.com.au/forms/report-damage-to-telstra-equipment>  
Ph: 13 22 03  
If you receive a message asking for a phone or account number say:  
“I don’t have one” then say “Report Damage” then press 1 to speak  
to an operator.



Telstra New Connections / Disconnections  
13 22 00



Telstra asset relocation enquiries: 1800 810 443 (AEST business  
hours only).  
[NetworkIntegrity@team.telstra.com](mailto:NetworkIntegrity@team.telstra.com)  
<https://www.telstra.com.au/consumer-advice/digging-construction>



Telstra Aerial Assets Group (overhead network)  
1800 047 909



CERTLOC Certified Locating Organisation (CLO)  
[certloc.com.au/locators/](https://certloc.com.au/locators/)



## End of document

**i** This document may exclude some files (eg. DWF or ZIP files)

This document was automatically generated at a point-in-time. Be aware that the source information from which this document was created may have changed since it was produced. This document may contain incomplete or out-of-date information. Always check your enquiry details in the BYDA Referral Service for the most recent information. For copyright information refer to individual responses.